

API No. <u>42-395-31259</u> Drilling Permit # <u>808348</u> SWR Exception Case/Docket No. _____		<b>RAILROAD COMMISSION OF TEXAS</b> <b>OIL &amp; GAS DIVISION</b> <b>APPLICATION FOR PERMIT TO DRILL, RECOMPLETE, OR RE-ENTER</b> <small>This facsimile W-1 was generated electronically from data submitted to the RRC.          A certification of the automated data is available in the RRC's Austin office.</small>				<b>FORM W-1</b> 07/2004 Permit Status: <b>Approved</b>	
1. RRC Operator No. <u>120027</u>		2. Operator's Name (as shown on form P-5, Organization Report) <u>CCI GULF COAST UPSTREAM LLC</u>			3. Operator Address (include street, city, state, zip): <u>STE 340</u> <u>821 E SOUTH EAST LOOP 323</u> <u>TYLER, TX 75701-0000</u>		
4. Lease Name <u>BRINKS</u>		5. Well No. <u>1</u>					
<b>GENERAL INFORMATION</b>							
6. Purpose of filing (mark ALL appropriate boxes): <div style="display: flex; justify-content: space-between;"> <span><input type="checkbox"/> New Drill</span> <span><input type="checkbox"/> Recompletion</span> <span><input type="checkbox"/> Reclass</span> <span><input checked="" type="checkbox"/> Field Transfer</span> <span><input type="checkbox"/> Re-Enter</span> </div> <div style="display: flex; justify-content: space-between;"> <span><input type="checkbox"/> Amended</span> <span><input type="checkbox"/> Amended as Drilled (BHL) (Also File Form W-1D)</span> </div>							
7. Wellbore Profile (mark ALL appropriate boxes): <div style="display: flex; justify-content: space-between;"> <span><input type="checkbox"/> Vertical</span> <span><input type="checkbox"/> Horizontal (Also File Form W-1H)</span> <span><input checked="" type="checkbox"/> Directional (Also File Form W-1D)</span> <span><input type="checkbox"/> Sidetrack</span> </div>							
8. Total Depth <u>16300</u>		9. Do you have the right to develop the minerals under any right-of-way ? <input checked="" type="checkbox"/> Yes <input type="checkbox"/> No		10. Is this well subject to Statewide Rule 36 (hydrogen sulfide area)? <input checked="" type="checkbox"/> Yes <input type="checkbox"/> No			
<b>SURFACE LOCATION AND ACREAGE INFORMATION</b>							
11. RRC District No. <u>05</u>		12. County <u>ROBERTSON</u>		13. Surface Location <div style="display: flex; justify-content: space-between;"> <span><input checked="" type="checkbox"/> Land</span> <span><input type="checkbox"/> Bay/Estuary</span> <span><input type="checkbox"/> Inland Waterway</span> <span><input type="checkbox"/> Offshore</span> </div>			
14. This well is to be located <u>5.4</u> miles in a <u>NE</u> direction from <u>Marquez Guad</u> which is the nearest town in the county of the well site.							
15. Section	16. Block	17. Survey <u>DE LA CONCEPCION MARQUEZ, M</u>		18. Abstract No. <u>A-25</u>	19. Distance to nearest lease line: <u>562</u> ft.	20. Number of contiguous acres in lease, pooled unit, or unitized tract: <u>170</u>	
21. Lease Perpendiculars: <u>641</u> ft from the <u>WEST</u> line and <u>1326</u> ft from the <u>NORTH</u> line. 22. Survey Perpendiculars: <u>8105</u> ft from the <u>SOUTHEAST</u> line and <u>9195</u> ft from the <u>SOUTHWEST</u> line.							
23. Is this a pooled unit? <input type="checkbox"/> Yes <input checked="" type="checkbox"/> No		24. Unitization Docket No:		25. Are you applying for Substandard Acreage Field? <input type="checkbox"/> Yes (attach Form W-1A) <input checked="" type="checkbox"/> No			
<b>FIELD INFORMATION</b> List all fields of anticipated completion including Wildcat.    List one zone per line.							
26. RRC District No.	27. Field No.	28. Field Name (exactly as shown in RRC records)		29. Well Type	30. Completion Depth	31. Distance to Nearest Well in this Reservoir	
<u>05</u>	<u>05189550</u>	<u>BALD PRAIRIE (CV CONSOLIDATED)</u>		<u>Gas Well</u>	<u>16100</u>	<u>0.00</u>	
<b>BOTTOMHOLE LOCATION INFORMATION</b> is required for DIRECTIONAL, HORIZONTAL, AND AMENDED AS DRILLED PERMIT APPLICATIONS (see W-1D attachment)							
<u>Remarks</u> [FILER Jul 10, 2015 5:26 PM]: Filing for field transfer.; [RRC STAFF Jul 22, 2015 2:22 PM]: There have been problems identified with this permit (see problem letter attachment). Notification sent.; [RRC STAFF Jul 22, 2015 4:41 PM]: Problems identified with this permit are resolved.				<u>Certificate:</u> I certify that information stated in this application is true and complete, to the best of my knowledge.  <div style="display: flex; justify-content: space-between;"> <div> <u>Frank Muser, Engineer</u>            Name of filer  <u>(512)4808800, x120</u>            Phone         </div> <div> <u>Jul 10, 2015</u>            Date submitted  <u>frank.muser@pghengineers.com</u>            E-mail Address (OPTIONAL)         </div> </div>			
RRC Use Only    Data Validation Time Stamp:    Jul 22, 2015 4:41 PM( 'As Approved' Version )							

Permit Status:	Approved
The RRC has not approved this application. Duplication or distribution of information is at the user's own risk.	

RAILROAD COMMISSION OF TEXAS  
OIL & GAS DIVISION  
APPLICATION FOR PERMIT TO DRILL, RECOMPLETE, OR RE-ENTER

This facsimile W-1 was generated electronically from data submitted to the RRC.  
A certification of the automated data is available in the RRC's Austin office.

Form W-1D 07/2004  
Supplemental Directional Well Information

Permit #	808348
Approved Date:	Jul 22, 2015

1. RRC Operator No. 120027	2. Operator's Name (exactly as shown on form P-5, Organization Report) CCI GULF COAST UPSTREAM LLC	3. Lease Name BRINKS	4. Well No. 1
Lateral Drainhole Location Information			
5. Field as shown on Form W-1 BALD PRAIRIE (CV CONSOLIDATED) (Field # 05189550, RRC District 05)			
6. Section	7. Block	8. Survey DE LA CONCEPCION MARQUEZ, M	9. Abstract 25
		10. County of BHL ROBERTSON	
11. Botton hole Lease Line Perpendiculars 562 ft. from the South line. and 587 ft. from the East line			
12. Bottom hole Survey Line Perpendiculars # 6759 ft. from the South line. and 10287 ft. from the West line			

NOTE: This plat does not represent a boundary survey.  
Location is staked from tract lines as evidenced  
by occupation, distances shown are not intended  
to be definitive in establishing actual title boundaries.

Location is apprx. 5.4 miles NE of Easterly  
"MARQUEZ" QUADRANGLE

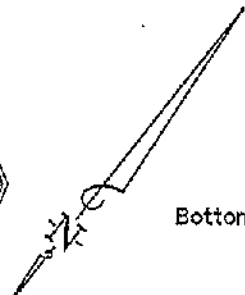
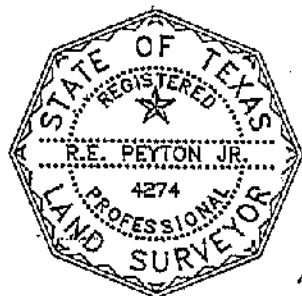
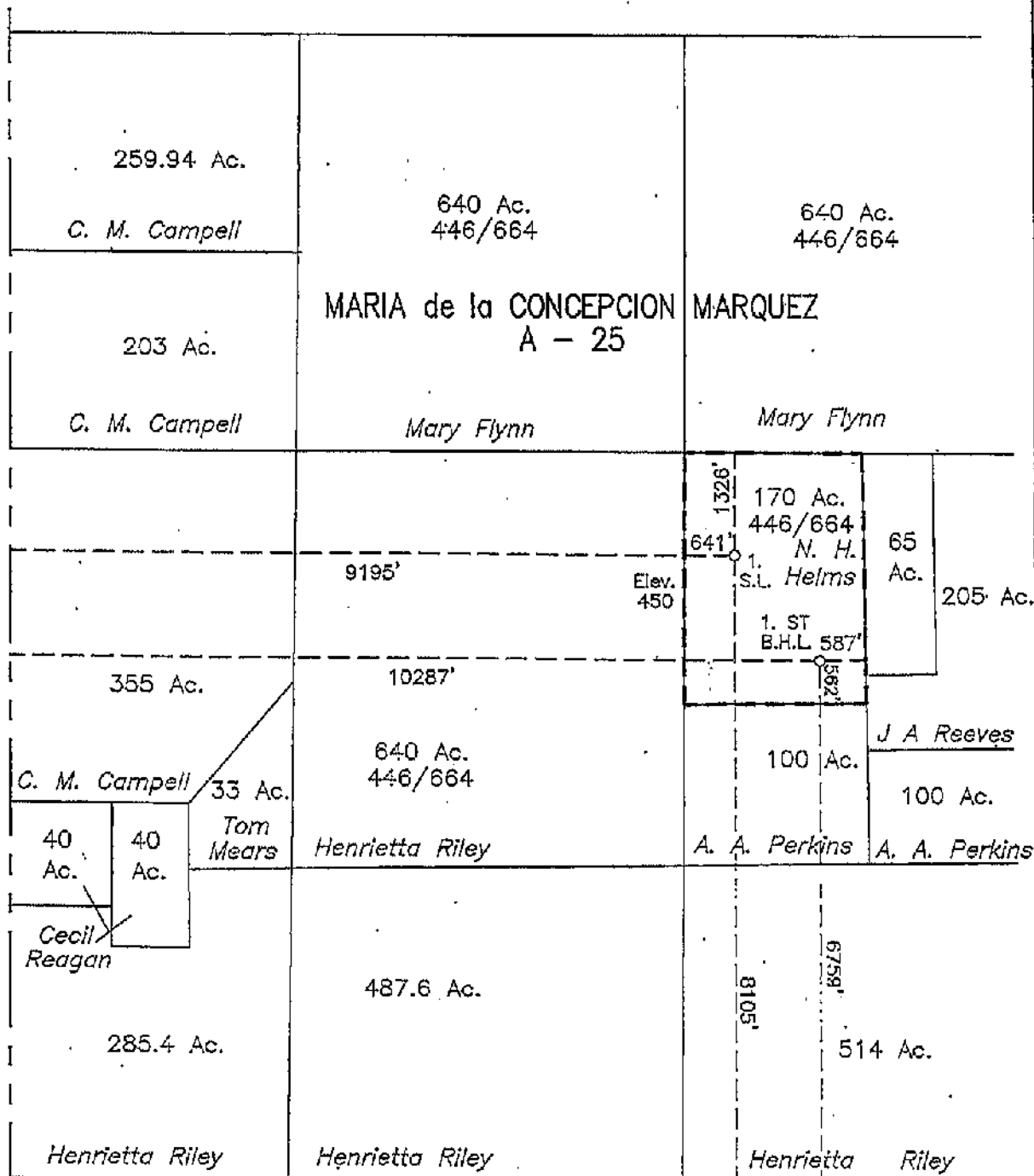

State Plane Coordinate Datum  
1927 North American Datum - Texas Central Zone  
Surface Location Bottom Hole Location  
X = 3,239,774.71' X = 3,241,459.00'  
Y = 575,545.23' Y = 575,149.00'  
Lat: 31°11'18.36" Lat: 31°11'13.85"  
Long: 96°22'03.31" Long: 96°21'44.09"  
Bottom Hole Location bears S 76°46' E - 1730' from Surface Location



I, R.E. Peyton, Jr., Registered Professional Land  
Surveyor, do hereby certify the above plat to be  
true and correct to best of my knowledge.  
Date: June 14, 2007 Tyler, Texas

*R.E. Peyton Jr.*

Registered Professional Land Surveyor No. 4274

WELL LOCATION PLAT  
CCI Gulf Coast Upstream, LLC.  
BRINKS No. 1 WELL  
MARIA DE LA CONCEPCION MARQUEZ  
SURVEY, A-25  
ROBERTSON COUNTY, TEXAS

From the Office of E.L.S. Surveying and Mapping, Inc.  
and Harry L. Johnson & Associates - Tyler, Texas

Job No. 273096